

>> Cam Stopper Type

SVC

VERTICAL LIFTING CLAMP

CHECK!



Operation manual & parts drawing

Cam, pad **cross type, normal pitch**

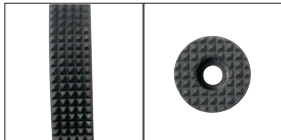

(P=3.0)

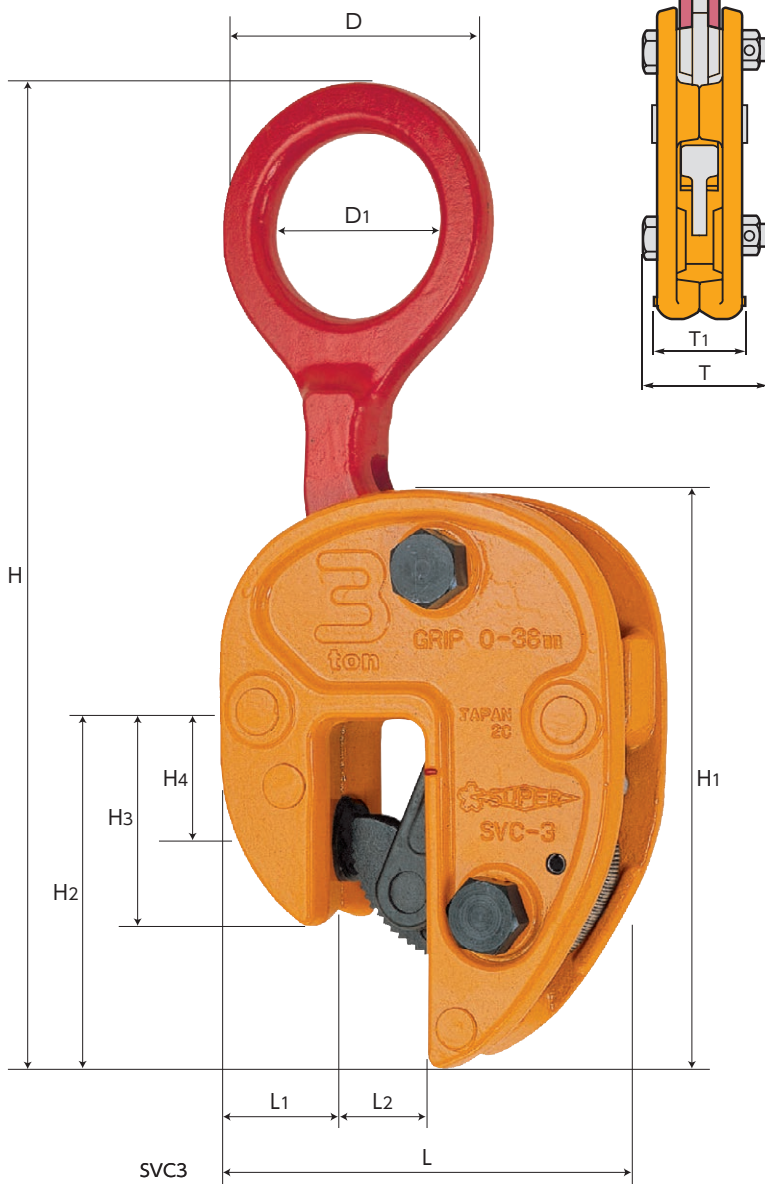

Example of use

⚠ Always lift a load at 2 or more points for safety.

Steel plate vertical lifting

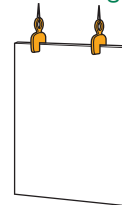

Steel beam lifting

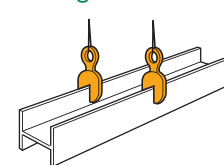

Steel plate turning-over

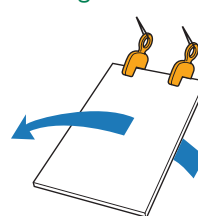

Pipe lifting

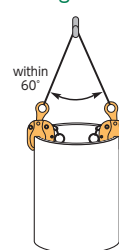

When lifting a pipe, position the clamps so that they face each other as shown on the drawing. (the lifting angle of the sling rope must be kept within 60°.)

Features

- For vertical lifting of steel plates and other steel structures (light-weight and compact type).
- All the major components are protected inside the body, with no protrusion, for easy handling operation.
- With the stopper, the cam stays locked in release position and the load is easy to set. As lifting is impossible unless the stopper is released, the safety can be easily confirmed.

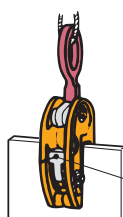

Tightening lock mechanism

When you push the stopper, a click sound is heard and the clamp grips firmly the workpiece.

Releasing lock mechanism

When you fully push downward the shackle as shown in the drawing, the cam retracts inside the main body, the releasing lock gets set and the release position is locked.

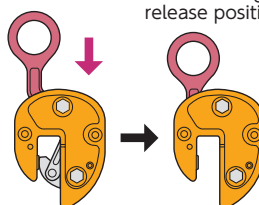

Item No.	Rated capacity (ton)	Clamp range (mm)	Size (mm)													N.W. (kg)
			L	L1	L2	H(MAX)	H1	H2	H3	H4	D	D1	T	T1	T2	
SVC0.5	0.5	0~19	108	29	22	210	138	85	54	33	54	35	45	31	9	1.6
SVC1	1	0~25	126	35	28	265	165	101	62	38	72	46	58	42	12	3.2
SVC2	2	0~32	152	43	35	330	200	120	73	45	96	61	72	56	16	6
SVC3	3	0~38	168	47	41	385	225	135	81	48	116	74	84	66	19	9
SVC5	5	0~50	212	59	54	485	276	162	99	61	146	92	101	81	25	18

★ Parts drawings and operation manuals can be downloaded from our website.

● For all the appendix, please refer to P.54 ~56



Vertical & lateral lifting clamps

Vertical lifting clamps

Lateral lifting clamps

Horizontal lateral lifting clamps, lifting hooks

Steel beam lifting clamps, balance

Screw clamp clamps

Beam clamps

Super foot locks, lifting hooks

Super lock hooks

Drum lift clamps

Lifting hooks for forklift, rail clamps

Reinforcing rod vertical lifting clamps

Clamp with fall arrest equipment